

2017 CONFERENCE

EPIDEMIOLOGY AND BIOSTATISTICS: FROM MOLECULES TO POPULATION

PROGRAM

MAY 30TH TO JUNE 2ND
THE BANFF CENTRE • BANFF, ALBERTA

CSEB WISHES TO THANK THE CONFERENCE SPONSORS FOR THEIR GENEROUS SUPPORT!

PLATINUM

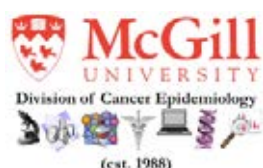

GOLD



SILVER



BRONZE

Epidemiology
and Biostatistics



CSEB WISHES TO THANK THE CONFERENCE SPONSORS FOR THEIR GENEROUS SUPPORT!

EXHIBIT BOOTH



COMMUNITY FRIEND



TABLE OF CONTENTS

| | |
|---------------------------------------|----|
| CSEB Sponsors..... | 2 |
| Acknowledgements..... | 4 |
| Floor Plans..... | 5 |
| Program Agenda..... | 6 |
| Concurrent Sessions At-a-Glance | 14 |
| Poster Presentations At-a-Glance..... | 33 |

ACKNOWLEDGEMENTS

Executive Committee

Sally Cleford
Faith Davis
Thy Dinh
Colleen Maxwell
Mark Oremus
Leah Phillips
Jessica Yu

Local Organizing Committee

Kathy Belton
Stephanie Booth
Katya Chudnovsky
Faith Davis
Doug Dover
Lisa Jensen
Jasdeep Kaur
Nicole Ofosu
Anh Pham
Leah Phillips
Andrea Schertzer
Kate Snedeker

Scientific Committee

Susan Bondy
Darren Brenner
Sally Cleford
Ilona Csizmadi
Faith Davis
Thy Dinh
Christine Friedenreich
Jeffrey Johnson
Mark Oremus
Kim Simmonds
Larry Svenson

Fundraising Committee

Sally Cleford
Ilona Csizmadi
Faith Davis
Christine Friedenreich
Thy Dinh
Mark Oremus

Abstract Reviewers

| | |
|------------------------|-----------------------|
| Kahina Abdesselam | Diestelkamp Naomi |
| Kelly Anderson | Ives Ntambwe |
| Sanjay Beesoon | Nnachebe Michael Onah |
| Monica Bienefeld | Karen Patte |
| Nigel Brockton | Anthony Perruccio |
| Elisa Candido | Maegan Prummel |
| Linda Dodds | Mylene Ratelle |
| Megan Farris | Alexis Schaink |
| Mark Ferro | Christine Sheppard |
| Dylan Franklin | John Spinelli |
| Christine Friedenreich | Julie Stratton |
| Dianne Groll | Larry Svenson |
| Julie Laroche | Suzanne Tyas |
| Yingyi Lin | James Valcour |
| John McLaughlin | Sarah Wallingford |
| Jessica McNeil | Christy Woolcott |
| Alexis Mickle | |

FLOOR PLANS

FIRST FLOOR

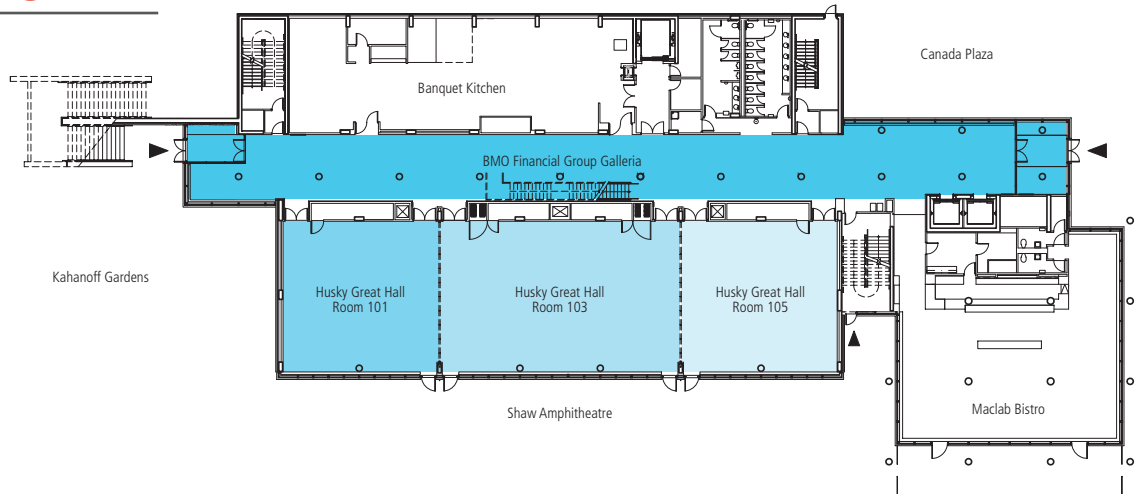

SECOND FLOOR

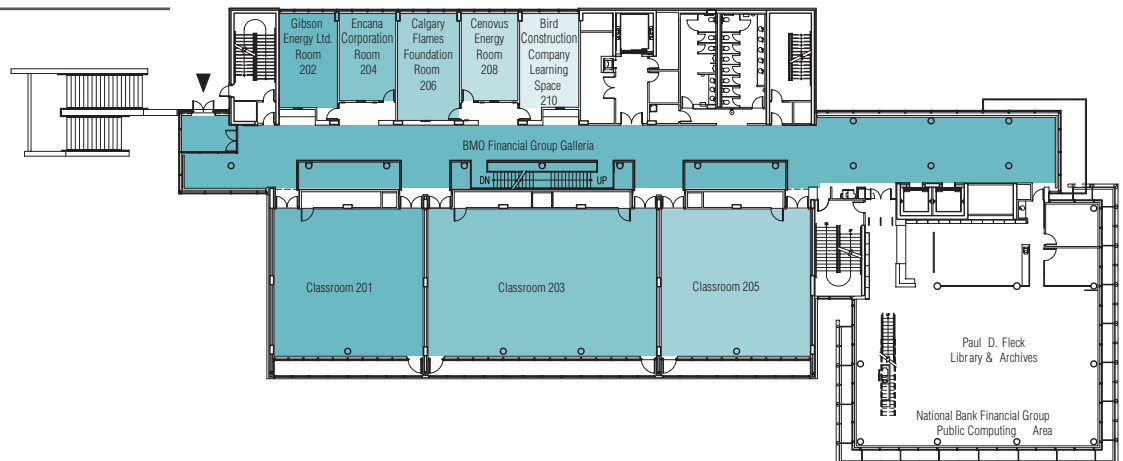

THIRD FLOOR

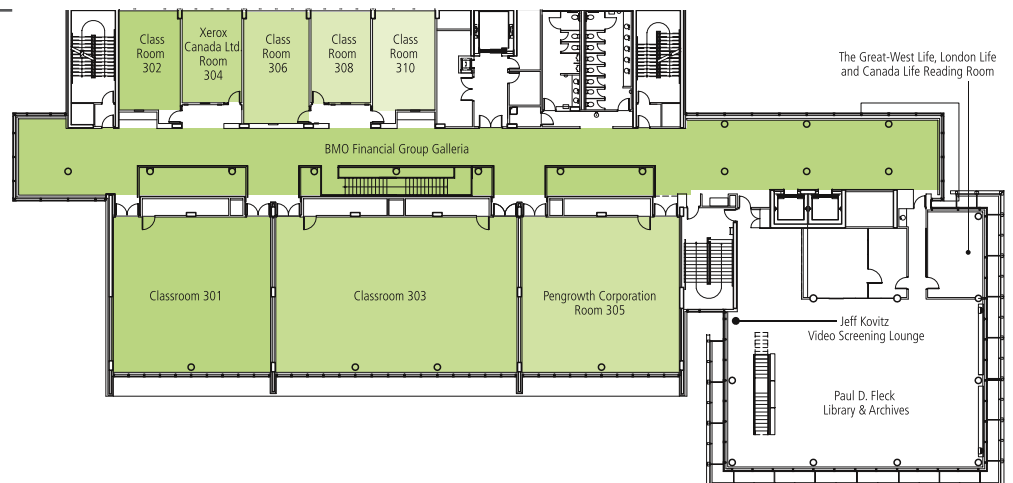

PROGRAM AGENDA

TUESDAY, MAY 30, 2017 (PRE-CONFERENCE DAY)

| | |
|---------------------|--|
| 8:30AM TO 9:00AM | BREAKFAST/PETIT-DÉJEUNER - VISTAS RESTAURANT (SALLY BORDEN BUILDING) |
| 9:00AM TO 12:00PM | MORNING WORKSHOP SERIES SÉRIE D'ATELIERS DU MATIN |
| ROOM: KC 303 | <p>1. SAS FOR GENOME-WIDE ASSOCIATION AND PREDICTION</p> <p><i>Presented by: RONG-CAI YANG, PhD, AF Professor of Statistical Genomics, Department of Agricultural, Food and Nutritional Science, University of Alberta</i></p> <p>Intensive research interest and activities have ben towards the use of high-density DNA markers such as single nucleotide polymorphisms (SNPs) for genome-wide association or prediction of complex diseases in humans or quantitative traits of economic and adaptive importance in plants and animals. The analysis of such association or prediction is often based on a supersaturated model known as whole genome regression (WGR). The effects of individual SNP markers across a genome can be estimable only if certain assumptions about the distribution of marker effects are imposed on the WGR model, leading to a large number of statistical and machine-learning models. This workshop will first provide an overview on these models. It will then illustrate how SAS can handle genome-wide association or prediction. Examples of using SAS procedures to analyze real-life genomics data sets will enable the workshop participants to gain valuable hand-on experiences with innovative uses of SAS for analysis of genetics/genomics data.</p> |
| ROOM: KC 302 | <p>2. METHODOLOGICAL AND ANALYTICAL CHALLENGES IN GENETIC EPIDEMIOLOGY</p> <p><i>Presented by: DR. DAVID MEYRE, PhD, Associate Professor, Dept. of Health Research Methods, Evidence, and Impact, McMaster University</i></p> <p>With the decrease in genotyping and sequencing costs, genetic epidemiology is gaining popularity. The workshop will cover the key concepts and methods in genetic epidemiology including the classification of genetic disorders, study designs and their implementation, genetic marker selection, genotyping and sequencing technologies, gene identification strategies, data analyses and data interpretation. I will address classic pitfalls in genetic association studies and provide guidelines for proper discovery and replication genetic association studies. This review will help the participant to appraise and conduct a high-quality genetic association study.</p> |
| ROOM: KC 306 | <p>3. UNDERSTANDING THE ROLE AND VALUE OF QUALITATIVE RESEARCH: AN INTRODUCTION TO AN ALTERNATE PARADIGM</p> <p><i>Presented by: DR. KATRINA MILANEY, Community Health Sciences, Cumming School of Medicine, University of Calgary and DR. REBECCA HAINES SAAH, Community Health Sciences, Cumming School of Medicine, University of Calgary</i></p> <p>This three hour workshop will blend information sharing and interactive learning to introduce the key concepts, approaches and theories underlying qualitative research. Participants will learn about different types of qualitative research, appropriate research questions for this approach, the value add of qualitative research and the role this approach can play in the advancement of scholarly discourse and knowledge creation in health and social sciences. Following the workshop participants will have a clear understanding of the distinctions between quantitative and qualitative research methods, rigor, analysis techniques, and ethical considerations. Examples will be provided throughout.</p> |

TUESDAY, MAY 30, 2017 (PRE-CONFERENCE DAY)

| | |
|-------------------|---|
| 12:30PM TO 1:00PM | LUNCH/DÉJEUNER - VISTAS RESTAURANT (SALLY BORDEN BUILDING) |
| 1:00PM TO 4:00PM | AFTERNOON WORKSHOP SERIES SÉRIE D'ATELIERS DE L'APRÈS-MIDI |
| ROOM: KC 303 | <p>1. SAS INTEGRATION WITH OPEN SOURCE STATISTICAL SOFTWARE <i>Presented by: NATHANIEL KENNEDY-NOBLE, Data Sciences Associate</i></p> <p>SAS has been integrated with several open source programming languages for many years. This workshop will review how SAS is integrated with two key programming languages Python and R. Nathaniel will discuss ways to enhance and improve your statistical analyses using both SAS and open source. The workshop will also review educational resources available to Epidemiology programs across Canada.</p> |
| ROOM: KC 302 | <p>2. EVIDENCE-BASED MEDICINE IN 2017 - IS IT MAKING THE GRADE? <i>Presented by: DR. EDDY LANG, Professor and Department Head for Emergency Medicine Cumming School of Medicine, University of Calgary Alberta Health Services, Calgary Zone</i></p> <p>By the end of this session participants will:</p> <ol style="list-style-type: none"> 1. Have an understanding of the evolution of EBM as a force in shaping healthcare delivery and policy 2. Describe the emergence of GRADE as an increasingly common approach in evaluating the certainty of research evidence both in systematic reviews and Clinical Practice Guidelines. 3. Develop an introductory hands-on understanding of GRADEpro software and the outputs it can generate to inform evidence synthesis and clinical guidance. <p>EBM was a term coined in the early '80s and despite variable interpretations can be argued to be considered a major advance in the interpretation and application of medical science. Emerging from EBM has been the industry of clinical practice guideline development which in and of itself has been described as a tower of Babel of methodologies and outputs. The GRADE approach has arisen from the need to achieve standardization in evidence interpretation and in mapping the trajectory from science to clinical decision-making. Participants in this workshop will develop an understanding of GRADE methodology and its limitations as well as practical tools for its use in support of clinical decision-making and health policy development.</p> |
| 5:30PM TO 7:00PM | WELCOME RECEPTION & PRE-REGISTRATION - KC GALLERIA 200 RÉCEPTION DE BIENVENUE ET PRÉ-INSCRIPTION <p>Join the planning committee and conference participants for some refreshments as we kick off another exciting CSEB Conference!</p> |

WEDNESDAY, MAY 31, 2017 (CONFERENCE DAY 1)

| | |
|--------------------|---|
| 7:30AM TO 8:30AM | BREAKFAST/PETIT-DÉJEUNER - VISTAS RESTAURANT (SALLY BORDEN BUILDING) |
| 8:30AM TO 10:30AM | PLENARY SESSIONS SEANCES PLENIERES |
| ROOM: KC 101/103 | <p>OBESITY: GENES, ENVIRONMENT, OR COMBINATION OF BOTH? OBÉSITÉ : GÈNES, ENVIRONNEMENT OU COMBINAISON DES DEUX ?</p> <p><i>Presented by: DR. DAVID MEYRE, PhD, Associate Professor, Dept. of Health Research Methods, Evidence, and Impact, McMaster University</i></p> <p>The worldwide rising prevalence of obesity is the underlying cause of numerous health complications and increased mortality. Being a complex and heritable disorder, obesity results from the interplay between genetic susceptibility and the environment. Twin, family and population-based studies have evidenced a strong inherited component for obesity. Attempts at understanding the genetic basis of obesity have identified numerous genes associated with syndromic monogenic, non-syndromic monogenic, oligogenic and polygenic obesity. Gene by environment interactions have a prominent role in obesity susceptibility. Mendelian randomization studies have provided causal inference in the sequence of events leading to obesity and its complications. Translational medical applications of genetic studies will be reviewed.</p> |
| ROOM: KC 101/103 | <p>CHALLENGES AND OPPORTUNITIES FOR SOCIAL EPIDEMIOLOGY COMMUNICATION SUR L'ÉPIDÉMIOLOGIE SOCIALE</p> <p><i>Presented by: DR. ANA DIEZ ROUX, MD, PhD, MPH, Dean and Distinguished Professor of Epidemiology, Dornsife School of Public Health, Drexel University</i></p> <ol style="list-style-type: none"> 1. To be aware of the epidemiological evidence on the social determinants of health 2. To understand the challenges in using epidemiological methods to address the social determinants of health 3. To identify promising new directions |
| 10:30AM TO 11:00AM | COFFEE BREAK/PAUSE CAFÉ - KC GALLERIA 200 |
| 11:00AM TO 12:30PM | CONCURRENT SESSIONS A SÉANCES SIMULTANÉE A |
| ROOM: KC 101/103 | A1: Environmental & Occupational A1 : Environnementale et professionnelle |
| ROOM: KC 301 | A2: Public Health/Population Health A2 : Santé publique et santé de la population |
| ROOM: KC 303 | A3: Epidemiologic Methods A3 : Méthodes épidémiologiques |
| ROOM: KC 305 | A4: Knowledge Transfer/Exchange A4 : Transfert/Échange de connaissances |

WEDNESDAY, MAY 31, 2017 (CONFERENCE DAY 1)

| | |
|-------------------|---|
| 12:30PM TO 1:45PM | LUNCH/DÉJEUNER - VISTAS RESTAURANT (SALLY BORDEN BUILDING) |
| 1:45PM TO 3:15PM | CONCURRENT SESSIONS B SÉANCES SIMULTANÉE B |
| ROOM: KC 101/103 | B1: Population Health B1 : Santé de la population |
| ROOM: KC 301 | B2: Diabetes, Cardiovascular Disease & Stroke B2 : Diabète, maladies cardiovasculaires et accidents vasculaires cérébraux |
| ROOM: KC 303 | B3: Health Services Research & Economics B3 : Recherche sur les services de santé et économie |
| ROOM: KC 305 | B4: Cancer |
| 3:15PM TO 4:30PM | POSTER VIEWING - KC GALLERIA 200 EXPOSITION D’AFFICHES <i>Coffee and tea and light snacks available</i> <i>Café, thé et goûter léger</i> |
| 6:30PM TO 9:00PM | SOCIAL EVENT: BREWSTERS MOUNTAIN BBQ ACTIVITÉ SOCIALE : BBQ BREWSTERS MOUNTAIN http://www.mountviewbbq.com/ Kick up your heels and enjoy an authentic mountain BBQ dinner including live music! |

THURSDAY, JUNE 1, 2017 (CONFERENCE DAY 2)

| | |
|---------------------------|--|
| 7:30AM TO 8:30AM | BREAKFAST/PETIT-DÉJEUNER - VISTAS RESTAURANT (SALLY BORDEN BUILDING) |
| 8:30AM TO 10:00AM | CONCURRENT SESSIONS C SÉANCES SIMULTANÉE C |
| ROOM: KC 101/103 | C1: Health Services Research & Economics C1 : Recherche sur les services de santé et économie |
| ROOM: KC 301 | C2: Cancer |
| ROOM: KC 303 | C3: Addictions & Mental Health C3 : Santé mentale et toxicomanie |
| ROOM: KC 305 | C4: Chronic Disease & Injury C4 : Blessures et maladies chroniques |
| 10:00AM TO 10:30AM | COFFEE BREAK/PAUSE CAFÉ - KC GALLERIA 200 |
| 10:30AM TO 12:00PM | CONCURRENT SESSIONS D SÉANCES SIMULTANÉE D |
| ROOM: KC 101/103 | D1: Public Health/Population Health D1 : Santé publique et santé de la population |
| ROOM: KC 301 | D2: Behavioural & Social Epidemiology D2 : Épidémiologie sociale et comportementale |
| ROOM: KC 303 | D3: Cancer |
| ROOM: KC 305 | D4: Nutrition, Physical Activity & Obesity D4 : Nutrition, activité physique et obésité |

THURSDAY, JUNE 1, 2017 (CONFERENCE DAY 2)

| | |
|-------------------|--|
| 12:00PM TO 1:15PM | LUNCH/DÉJEUNER - VISTAS RESTAURANT (SALLY BORDEN BUILDING) |
| 1:15PM TO 2:45PM | CONCURRENT SESSIONS E SÉANCES SIMULTANÉE E |
| ROOM: KC 101/103 | E1: Building Cancer Research Capacity E1 : Renforcer la capacité de recherche sur le cancer |
| ROOM: KC 301 | E2: Biostatistics E2 : Biostatistique |
| ROOM: KC 303 | E3: Clinical- & Pharmaco-Epidemiology E3 : Épidémiologie clinique et pharmaco-épidémiologie |
| ROOM: KC 305 | E4: Infectious Disease E4 : Maladies infectieuses |
| 2:45PM TO 4:00PM | POSTER VIEWING - KC GALLERIA 200 EXPOSITION D’AFFICHES <i>Coffee and tea and light snacks available</i> <i>Café, thé et goûter léger</i> |
| 4:00PM TO 5:30PM | CONCURRENT SESSIONS F SÉANCES SIMULTANÉE F |
| ROOM: KC 101/103 | F1: Public Health/Population Health F1 : Santé publique et santé de la population |
| ROOM: KC 301 | F2: Cancer |
| ROOM: KC 303 | F3: Biostatistics F3 : Biostatistique |
| ROOM: KC 305 | F4: Environmental & Occupational/Surveillance & Spatial Epidemiology F4 : Épidémiologie environnementale et professionnelle/épidémiologie spatiale et de la surveillance |
| 5:45PM TO 6:45PM | SOCIAL EVENT: STUDENT SPEED NETWORKING - ROOM: KC 105 ACTIVITÉ SOCIALE : RÉSEAUTAGE-MINUTE POUR LES ÉTUDIANTS |
| 6:30PM + | SOCIAL EVENT: STUDENT & MENTOR PUB NIGHT ACTIVITÉ SOCIALE : SOIRÉE AU BISTROT ENTRE ÉTUDIANTS ET MENTORS Join students and mentors for an evening out on the town in Banff. Details about the first stop of the night will be announced at the conference. |

FRIDAY, JUNE 2, 2017 (CONFERENCE DAY 3)

| | |
|---------------------|--|
| 7:30AM TO 8:30AM | BREAKFAST/PETIT-DÉJEUNER - VISTAS RESTAURANT (SALLY BORDEN BUILDING) |
| 8:30AM TO 9:45AM | WORKSHOP SERIES SÉRIE D'ATELIERS |
| ROOM: KC 301 | <p>1. WORKING AT THE NEXUS OF RESEARCH AND POLICY: INTERNATIONAL JOINT POLICY COMMITTEE OF THE SOCIETIES OF EPIDEMIOLOGY (IJPC-SE)</p> <p><i>Presented by: DR. MARK OREMUS, University of Waterloo, President, Canadian Society of Epidemiology and Biostatistics (CSEB)</i></p> <p>This workshop will describe the vision, mission, structure, and role of the IJPC-SE, an international consortium of 21 national and international epidemiology organizations spanning six continents. These organizations have joined together to form a voluntary joint policy committee called the IJPC-SE. Our goal is to ensure health for all through ethical, independent and transparent science, as well as through the production of position statements and evidence briefs.</p> |
| ROOM: KC 303 | <p>2. INSIGHTS FROM BIG DATA: CREATING THE EVIDENCE BASE FOR HEALTH POLICY DEVELOPMENT</p> <p><i>Presented by: DR. LARRY SVENSON, Executive Director, Analytics and Performance Reporting, Alberta Health</i></p> <p>Maximizing the use of data collected through interactions with the health care system are critical to evidence-based decision making. This workshop will examine challenges and opportunities faced when using data to inform and evaluate the development of public health policies. Examples will be drawn from experiences in the Alberta context and show the value of linking across large administrative health data bases, and the opportunities for linkage to non-health data.</p> |
| ROOM: KC 305 | <p>3. STATISTICAL CHALLENGES IN DISEASE RISK PREDICTION</p> <p><i>Presented by: Dr. LISA LIX, PhD P.Stat., Professor, Department of Community Health Sciences & George and Fay Yee Centre for Healthcare Innovation, University of Manitoba</i></p> <p>Predicting risk of a health outcome, such as the onset of a chronic disease or a critical health event has received considerable attention in both the clinical and statistical literature in recent years. This workshop will examine challenges faced when developing, assessing, and validating risk prediction models. Examples will be drawn from the use of these models in musculoskeletal research. Key considerations in risk prediction modeling will be discussed, including the rationale for selection of a statistical or machine-learning model, selection of predictor variables and variable reduction techniques to develop a parsimonious model, evaluation of predictive performance, and validation.</p> |

FRIDAY, JUNE 2, 2017 (CONFERENCE DAY 3)

| | |
|--------------------|--|
| 9:45AM TO 10:15AM | COFFEE BREAK/PAUSE CAFÉ - KC GALLERIA 200 |
| 10:15AM TO 11:45PM | WORKSHOP SERIES SÉRIE D'ATELIERS |
| ROOM: KC 303 | <p>1. STUDENT CAREER WORKSHOP</p> <p><i>Presented by: RAY DEONANDAN, Assistant Professor, Interdisciplinary School of Health Sciences, University of Ottawa, JAMES TALBOT, Adjunct Professor, School of Public Health, University of Alberta, and LEAH PHILLIPS, Director of Research, College of Licensed Practical Nurses of Alberta</i></p> <p>Representatives from the worlds of academia, government, and industry will give career-planning advice for students in Epidemiology, Biostatistics, Public Health, and Health Sciences. What skills do you need to acquire? Where can you find job opportunities? Attendees should come armed with questions.</p> |
| ROOM: KC 305 | <p>2. SCIENCE COMMUNICATION WORKSHOP</p> <p><i>Presented by: MS. KAYLEE BYERS, PhD candidate in the Department of Interdisciplinary Studies at the University of British Columbia and MICHAEL UNGER, Program Coordinator at the H.R. MacMillan Space Centre in Vancouver</i></p> <p>Science is a way of understanding the world around us, but science needs to be understood by all for it to be effective. Kaylee and Michael run Nerd Nite Vancouver, a science-based bar lecture series held at the Fox Cabaret, it encourages science communication in an informal setting. This workshop includes three different mini-modules, entitled 'Telling your Science as a Story', 'Understanding your Audience', and 'Dejargonizing your Science: Using Simple Language to Communicate Effectively'. Participants in this workshop will develop an understanding of the importance of science communication and understand a variety of different creative ways to communicate to the public. By the end of this session, participants will:</p> <ol style="list-style-type: none"> 1. Explain how telling your science as a story helps to engage an audience and increase receptivity of your science 2. Will be able to pitch a story to a variety of different audiences 3. Will also be able to identify jargon and cross jargon, and use simple language to explain a complex topic |
| 11:45AM TO 12:15PM | CSEB AWARDS PRESENTATIONS - ROOM: KC 101/103 REMISE DE PRIX DE LA SCEB <ul style="list-style-type: none"> • CSEB Early Career • Geoffrey Howe Award • CSEB Distinguished Service • Lifetime Achievement |
| 12:15PM TO 12:30PM | CLOSING REMARKS - KC 101/103 MOT DE LA FIN ET AJOURNEMENT <p><i>Presented by: DR. MARK OREMUS, University of Waterloo, President, Canadian Society of Epidemiology and Biostatistics (CSEB)</i></p> |

CONCURRENT SESSIONS AT-A-GLANCE

WEDNESDAY, MAY 31, 2017 (CONCURRENT SESSIONS)

11:00AM TO 12:30PM CONCURRENT SESSION A

A1: ENVIRONMENTAL & OCCUPATIONAL - ROOM: KC 101/103

A1 : ENVIRONNEMENTALE ET PROFESSIONNELLE

- A1.1 SOME CHALLENGES IN MEASURING ULTRA-FINE PARTICLES AND DEVELOPING A LAND USE REGRESSION MODEL IN GREATER MONTREAL AREA

Presented by:

- Shilpa LN Karumanchi, Student, University of Montreal

- A1.2 A COMMUNITY-BASED PILOT STUDY ASSESSING THE WORK-RELATED MUSCULOSKELETAL RISK PERCEPTION AMONG GOVERNMENT- AND PRIVATE-SPONSORED SYRIAN REFUGEES IN CANADA

Presented by:

- Sonja Senthanaar, PhD Candidate, University of Waterloo

- A1.3 POPULATION ATTRIBUTABLE RISK AND IMPACT FRACTIONS FOR LUNG CANCER AND RESIDENTIAL RADON – A CANADIAN PERSPECTIVE

Presented by:

- Tasha Narain, Research Associate, Queen's University

- A1.4 AN INVESTIGATION OF OCCUPATIONAL EXPOSURE TO MONOCYCLIC AROMATIC HYDROCARBONS AND LUNG CANCER RISK IN THE METROPOLITAN MONTRÉAL AREA

Presented by:

- Hunter Warden, Graduate Student, Queen's University

- A1.5 PERCEIVED NEIGHBOURHOOD SAFETY AND SYSTOLIC BLOOD PRESSURE IN CHILDREN: FINDINGS FROM THE QUALITY COHORT

Presented by:

- Tracie Barnett, Professor, INRS Institut Armand Frappier

WEDNESDAY, MAY 31, 2017 (CONCURRENT SESSIONS)

11:00AM TO 12:30PM CONCURRENT SESSION A

A2: PUBLIC HEALTH/POPULATION HEALTH - ROOM: KC 301

A2 : SANTÉ PUBLIQUE ET SANTÉ DE LA POPULATION

- A2.1 AREA-LEVEL DEPRIVATION AND EMERGENCY DEPARTMENT USE IN EDMONTON AND CALGARY, AB: AN ANALYSIS OF RATES AND TRENDS FROM 2010 TO 2016
[Presented by:](#)
- Jordan Ross, Analyst, Alberta Health Services
-
- A2.2 FEBRILE SEIZURE RISK FOLLOWING CHILDHOOD VACCINATION IN ALBERTA; A STUDY AIMED AT IMMUNIZATION QUALITY IMPROVEMENT IN CHILDREN 6 TO 23 MONTHS
[Presented by:](#)
- Muddassir Siddiqui, Analyst, Alberta Health Services
-
- A2.3 ALCOHOL CONSUMPTION PREVALENCE AND ADHERENCE TO CANCER PREVENTION RECOMMENDATIONS FOR ALCOHOL CONSUMPTION AMONG ADULTS: CROSS-SECTIONAL RESULTS FROM ALBERTA'S TOMORROW PROJECT
[Presented by:](#)
- Tiffany Haig, MSc Candidate, Alberta Health Services
-
- A2.4 ASSOCIATIONS BETWEEN CANCER PREVENTION KNOWLEDGE, ATTITUDES AND BEHAVIOURS IN THE ALBERTA PREVENTS SURVEY
[Presented by:](#)
- Anne Grundy, Research Associate, Department of Social and Preventive Medicine, Université de Montréal and Centre de recherche du CHUM (CRCHUM)
-
- A2.5 ESTIMATED REDUCTIONS IN PROVIDER-INITIATED PRETERM BIRTHS AND CORRESPONDING MATERNAL AND NEWBORN HOSPITAL LENGTH OF STAY UNDER A UNIVERSAL ASPIRIN PROPHYLAXIS STRATEGY IN CANADA
[Presented by:](#)
- Alison Park, Senior Epidemiologist Institute for Clinical Evaluative Sciences (ICES)

WEDNESDAY, MAY 31, 2017 (CONCURRENT SESSIONS)

11:00AM TO 12:30PM CONCURRENT SESSION A

A3: EPIDEMIOLOGIC METHODS - ROOM: KC 303

A3 : MÉTHODES ÉPIDÉMIOLOGIQUES

- A3.1 A QUALITATIVE PILOT STUDY TO INFORM PARTICIPANT ENGAGEMENT STRATEGIES IN A LARGE PROSPECTIVE COHORT STUDY

Presented by:

- Jenna Gagne, Research Assistant, Alberta's Tomorrow Project, CancerControl Alberta, Alberta Health Services

- A3.2 MEASURING EQUITY IN HEALTH CARE THROUGH DATA LINKAGE

Presented by:

- Christina Catley, Senior Analyst, Canadian Institute for Health Information

- A3.3 CAN HEALTH ADMINISTRATIVE DATA BE USED TO ACCURATELY IDENTIFY CASES OF TRAVEL-RELATED DISEASE IN ONTARIO?

Presented by:

- Rachel Savage, PhD Student, University of Toronto

- A3.4 CANCER IN ONTARIO WORKERS FROM 1983-2016: RESULTS FROM THE OCCUPATIONAL DISEASE SURVEILLANCE SYSTEM (ODSS)

Presented by:

- Saul Feinstein, Research Associate, Cancer Care Ontario

- A3.5 ETHNIC VARIATION IN PREDIABETES INCIDENCE AMONG RECENT IMMIGRANTS AND LONG-TERM RESIDENTS TO CANADA: A COMPETING RISK ANALYSIS

Presented by:

- Ghazal Fazli, PhD Candidate, University of Toronto

WEDNESDAY, MAY 31, 2017 (CONCURRENT SESSIONS)

11:00AM TO 12:30PM CONCURRENT SESSION A

A4: KNOWLEDGE TRANSFER/EXCHANGE - ROOM: KC 305

A4 : TRANSFERT/ÉCHANGE DE CONNAISSANCES

A4.1 PREDICTING IMPORTANT PATIENT DOMAINS FOR GLAUCOMA MANAGEMENT

Presented by:

- Lavanya Uruthiramoorthy, Graduate Student, Western University

4.2 A SYSTEMATIC REVIEW OF THE ROLE OF COPING STRATEGIES IN THE ASSOCIATION BETWEEN CAREGIVING COMPLEXITY AND QUALITY OF LIFE AMONG PARENTS OF CHILDREN WITH CHRONIC ILLNESS OR DISABILITY

Presented by:

- Alana Fairfax, Master's student, University of Ottawa

A4.3 COMPARATIVE HUMAN EXPOSURE TO ANTIMICROBIAL RESISTANT ESCHERICHIA COLI FROM FOOD ANIMALS USING INTEGRATIVE ASSESSMENT MODELLING: A FARM TO FORK APPROACH

Presented by:

- Colleen Murphy, Veterinary Epidemiologist, NSERC Fellow placed at the Centre for Food-borne, Environmental and Zoonotic Infections

A4.4 A KNOWLEDGE TRANSLATION STRATEGY FOR THE CANADIAN POPULATION ATTRIBUTABLE RISK (COMPARE) PROJECT

Presented by:

- Leah Smith, Epidemiologist, Canadian Cancer Society

A4.5 CORNEAL BIOMECHANICAL PROPERTIES AFTER SMILE VERSUS FLEX, LASIK, LASEK, OR PRK: A SYSTEMATIC REVIEW AND META-ANALYSIS

Presented by:

- Hui Guo, Graduate Student, Schulich School of Medicine and Dentistry, The University of Western Ontario, London, Canada

WEDNESDAY, MAY 31, 2017 (CONCURRENT SESSIONS)

1:45PM TO 3:15PM CONCURRENT SESSION B

B1: POPULATION HEALTH - ROOM: KC 101/103

B1 : SANTÉ DE LA POPULATION

B1.1 CANADIAN LONGITUDINAL STUDY ON AGING: A PLATFORM FOR INTERDISCIPLINARY RESEARCH

Presented by:

- Lauren Griffith, associate professor, Department of Health Research Methods, Evidence, and Impact, McMaster University
- Istvan Molnar-Szakacs, data access officer, Canadian Longitudinal Study on Aging
- Mark Oremus, associate professor, School of Public Health and Health Systems

B2: DIABETES, CARDIOVASCULAR DISEASE & STROKE - ROOM: KC 301

B2 : DIABÈTE, MALADIES CARDIOVASCULAIRES ET ACCIDENTS VASCULAIRES CÉRÉBRAUX

B2.1 THE IMPACT OF SELF-EFFICACY ON HOSPITALIZATION RATES AND IN MANAGING CHRONIC DISEASE IN A CANADIAN TYPE-2 DIABETES COHORT

Presented by:

- Haoyu Zhao, Graduate student, School of Public Health, University of Alberta

B2.2 CHANGES IN BODY MASS INDEX AND INCIDENCE OF DIABETES: A LONGITUDINAL STUDY OF ALBERTA'S TOMORROW PROJECT COHORT

Presented by:

- Ming Ye, Postdoctoral Fellow, Alliance for Canadian Health Outcomes Research in Diabetes, University of Alberta

B2.3 COMORBID DEPRESSION AND ANXIETY SYMPTOMS AND THE RISK OF INCIDENT DIABETES: PROSPECTIVE RESULTS FROM THE LIFELINES COHORT STUDY

Presented by:

- Sonya Deschênes, Postdoctoral Fellow, McGill University

B2.4 ECONOMIC VULNERABILITY AND CHRONIC DISEASE RISK: A POPULATION-BASED STUDY INVESTIGATING THE ASSOCIATION BETWEEN FOOD INSECURITY AND INCIDENT TYPE 2 DIABETES IN CANADIAN ADULTS

Presented by:

- Christopher Tait, PhD Candidate, Dalla Lana School of Public Health, University of Toronto

B2.5 THE PROGRESSION FROM PREDIABETES TO TYPE 2 DIABETES AMONG RECENT IMMIGRANTS AND LONG-TERM RESIDENTS TO CANADA: A POPULATION-BASED COHORT STUDY

Presented by:

- Ghazal Fazli, PhD Candidate, University of Toronto

WEDNESDAY, MAY 31, 2017 (CONCURRENT SESSIONS)

1:45PM TO 3:15PM CONCURRENT SESSION B

B3: HEALTH SERVICES RESEARCH & ECONOMICS - ROOM: KC 303

B3 : RECHERCHE SUR LES SERVICES DE SANTÉ ET ÉCONOMIE

- B3.1 REDUCING SCORING UNCERTAINTY IN THE EQ-5D HEALTH UTILITIES: A BAYESIAN APPROACH USING SPATIAL GAUSSIAN CORRELATION STRUCTURE

Presented by:

- Shahriar Shams, PhD Student, University of Toronto

- B3.2 USING PRIMARY CARE ELECTRONIC MEDICAL RECORD DATA AND MACHINE LEARNING TO PREDICT ACUTE CARE USE

Presented by:

- Colin Weaver, Master's Student, University of Calgary

- B3.3 HOMELESSNESS STATUS AND THE FREQUENCY OF ACCESSING PRIMARY CARE IN THE CONTEXT OF A LARGE CANADIAN CITY: A MODELING STUDY

Presented by:

- Laura Rivera, Research Associate, University of Calgary

- B3.4 A POPULATION-BASED STUDY OF PATIENT AND SYSTEM FACTORS ASSOCIATED WITH ADVANCED CUTANEOUS MELANOMA IN ONTARIO

Presented by:

- Meaghan Mavor, Master's student, Queen's University

- B3.5 USING MORTALITY RATE FORECASTING IN HEALTH ECONOMIC EVALUATION

Presented by:

- Mohammad Kaviul Khan, Clinical Research Project Coordinator, Child Health Evaluative Sciences, The Hospital for Sick Children

WEDNESDAY, MAY 31, 2017 (CONCURRENT SESSIONS)

1:45PM TO 3:15PM CONCURRENT SESSION B

B4: CANCER - ROOM: KC 305

B4.1 PREVENTING ALCOHOL-RELATED CANCER: WHAT IF EVERYONE DRANK WITHIN THE GUIDELINES?

Presented by:

- Elisa Candido, Acting Group Manager, Cancer Care Ontario

B4.2 EFFECTS OF SLEEP DURATION ON ALL CANCER INCIDENCE RATES IN THE ALBERTA TOMORROW PROJECT COHORT

Presented by:

- Jessica McNeil, Postdoctoral Fellow, Alberta Health Services

B4.3 THE LONG-TERM RISK OF CARDIOVASCULAR DISEASE INCIDENCE IN LYMPHOMA SURVIVORS: A SYSTEMATIC REVIEW AND META-ANALYSIS

Presented by:

- Alexis Mickle, Graduate Student, Alberta Health Services

B4.4 THE LONG-TERM RISK OF CARDIOVASCULAR DISEASE MORTALITY IN LYMPHOMA SURVIVORS COMPARED TO THE GENERAL POPULATION: A SYSTEMATIC REVIEW AND META-ANALYSIS OF OBSERVATIONAL STUDIES

Presented by:

- Devon Boyne, PhD Student, Alberta Health Services

B4.5 BACILLUS CALMETTE-GUERIN (BCG) VACCINATION AND LYMPHOMA: PRELIMINARY RESULTS FROM A SYSTEMATIC REVIEW AND META-ANALYSIS

Presented by:

- Marie-Claude Rousseau, Full Professor, Institut National de la Recherche Scientifique

THURSDAY, JUNE 1, 2017 (CONCURRENT SESSIONS)

8:30AM TO 10:00AM CONCURRENT SESSION C

C1: HEALTH SERVICES RESEARCH & ECONOMICS - ROOM: KC 101/103

C1 : RECHERCHE SUR LES SERVICES DE SANTÉ ET ÉCONOMIE

C1.1 CHARACTERISTICS AND EARLY HEALTHCARE USE OF REFUGEES IN ONTARIO, CANADA

Presented by:

- Amanda Alberga, Epidemiologist, Institute for Clinical Evaluative Sciences (ICES)

C1.2 EFFECTS OF BEHAVIOURAL RISK FACTORS ON HIGH COST USERS OF HEALTHCARE: A POPULATION-BASED STUDY

Presented by:

- Amanda Alberga, Epidemiologist, Institute for Clinical Evaluative Sciences (ICES)

C1.3 LEVERAGING A PROVINCIAL NETWORK TO DESCRIBE POPULATION TRENDS IN PALLIATIVE CARE SERVICE USE IN ONTARIO

Presented by:

- Lauren Della Mora, Senior Analyst, Cancer Care Ontario

C1.4 HEALTH CARE SERVICE UTILIZATION AND UNMET HEALTH CARE NEEDS OF RURAL INDIGENOUS PEOPLES IN CANADA: A POPULATION-BASED STUDY

Presented by:

- Arlanna Pugh, Graduate Student, Queen's University

C1.5 INVESTIGATING THE VALUE OF A TAILORED KNOWLEDGE SYNTHESIS APPROACH FOR RARE DISEASES: FOCUS GROUPS WITH VARIOUS STAKEHOLDERS

Presented by:

- Kylie Tingley, PhD candidate, University of Ottawa

C2: CANCER - ROOM: KC 301

C2.1 PROJECTION OF CANCER INCIDENCE IN ALBERTA'S TOMORROW PROJECT FROM 2017 TO 2036

Presented by:

- Jian-Yi Xu, Biostatistician, Alberta's Tomorrow Project, CancerControl Alberta, Alberta Health Services, Alberta

C2.2 LIFESTYLE AND CANCER PREVENTION IN CANADA: ESTIMATING THE CURRENT AND FUTURE AVOIDABLE CANCER BURDEN

Presented by:

- Darren Brenner, Research Scientist/Adj. Assistant Professor, University of Calgary

C2.3 SHIFT WORK PATTERNS, CHRONOTYPE AND OVARIAN CANCER RISK

Presented by:

- Lisa Leung, Student, Department of Public Health Sciences, Queen's University

C2.4 A CANCER PROFILE FOR FIRST NATIONS IN ONTARIO ACHIEVED THROUGH LINKED REGISTRY DATA AND PARTNERSHIPS

Presented by:

- Sehar Jamal, Research Associate, Cancer Care Ontario

C2.5 COLORECTAL CANCER TREATMENT FOR PATIENTS WITH A SEVERE PSYCHIATRIC ILLNESS: EVIDENCE FOR INEQUALITIES IN A UNIVERSAL HEALTH CARE SYSTEM

Presented by:

- Alyson Mahar, Postdoctoral Research Associate, Sunnybrook Health Sciences Centre

THURSDAY, JUNE 1, 2017 (CONCURRENT SESSIONS)

8:30AM TO 10:00AM CONCURRENT SESSION C

C3: ADDICTIONS & MENTAL HEALTH - ROOM: KC 303

C3 : SANTÉ MENTALE ET TOXICOMANIE

- C3.1 TRENDS IN STANDARDIZED MORTALITY AMONG INDIVIDUALS WITH SCHIZOPHRENIA FROM 1993 TO 2012: A POPULATION-BASED STUDY

Presented by:

- Evgenia (Jenny) Gatov, Epidemiologist, Institute for Clinical Evaluative Sciences (ICES)

- C3.2 TEST-RETEST RELIABILITY OF CHILD AND ADOLESCENT PSYCHIATRIC DISORDER CLASSIFICATIONS ASSESSED USING STANDARDIZED DIAGNOSTIC INTERVIEWS: A SYSTEMATIC REVIEW AND META-ANALYSIS

Presented by:

- Laura Duncan, Research Coordinator, Offord Centre for Child Studies, McMaster University

- C3.3 ASSOCIATIONS BETWEEN PHYSICAL ILLNESS AND SUICIDAL BEHAVIOURS AMONG ADOLESCENTS AND YOUNG ADULTS

Presented by:

- Mark Ferro, Assistant Professor, University of Waterloo

- C3.4 QUALITY OF LIFE IN PARENTS OF CHILDREN WITH EPILEPSY: 10 YEARS AFTER DIAGNOSIS

Presented by:

- Klajdi Puka, Graduate Student, Western University; Children's Health Research Institute; Lawson Health Research Institute

- C3.5 A HEAVY BURDEN ON YOUNG MINDS: NOVEL INSIGHTS INTO THE GLOBAL BURDEN OF SUBSTANCE USE IN ADOLESCENTS FROM 73 LOW- AND MIDDLE-INCOME COUNTRIES (LMICS)

Presented by:

- Christopher, Tait, PhD Candidate, Dalla Lana School of Public Health, University of Toronto

THURSDAY, JUNE 1, 2017 (CONCURRENT SESSIONS)

8:30AM TO 10:00AM CONCURRENT SESSION C

C4: CHRONIC DISEASE & INJURY - ROOM: KC 305

C4 : BLESSURES ET MALADIES CHRONIQUES

- C4.1 EARLY MOBILIZATION FOLLOWING ARTHROSCOPIC ROTATOR CUFF REPAIR; A SINGLE-BLIND, RANDOMIZED CONTROL TRIAL

Presented by:

- Anelise Silveira, Research Associate, Alberta Health Services

- C4.2 VALIDATION OF A KIDNEY FAILURE RISK EQUATION IN A POPULATION-BASED COHORT OF ALBERTA ADULTS WITH CHRONIC KIDNEY DISEASE

Presented by:

- Rob Weaver, Statistical Associate, Cumming School of Medicine, University of Calgary

- C4.3 DEPRESSIVE SYMPTOMS IN ADOLESCENTS AND YOUNG ADULTS WITH EPILEPSY 10 YEARS AFTER DIAGNOSIS: A TEST OF THE STRESS PROCESS

Presented by:

- Samanpreet Brar, Graduate Student, Western University

- C4.4 CHRONIC DISRUPTIVE PAIN IN EMERGING ADULTS WITH AND WITHOUT CHRONIC HEALTH CONDITIONS: THE MODERATING ROLE OF PSYCHIATRIC DISORDERS

Presented by:

- Rana Qadeer, Student, McMaster University

- C4.5 TIME TRENDS OF THE INCIDENCE, PREVALENCE, AND POST-DIAGNOSIS MORTALITY OF PARKINSONISM

Presented by:

- Jessica Wong, Master's student, Dalla Lana School of Public Health, University of Toronto

THURSDAY, JUNE 1, 2017 (CONCURRENT SESSIONS)

10:30AM TO 12:00PM CONCURRENT SESSION D

D1: PUBLIC HEALTH/POPULATION HEALTH - ROOM: KC 101/103

D1 : SANTÉ PUBLIQUE ET SANTÉ DE LA POPULATION

D1.1 KNOWLEDGE TRANSLATION AND DISSEMINATION OF NEW STATISTICS ON HPV-ASSOCIATED CANCERS IN CANADA

Presented by:

- Leah Smith, Epidemiologist, Canadian Cancer Society

D1.2 CANCER RISK FACTORS AND SCREENING AMONG INUIT IN ONTARIO AND OTHER REGIONS OF CANADA

Presented by:

- Maegan Prummel, Senior Research Associate, Cancer Care Ontario

D1.3 COLORECTAL CANCER RISK STRATIFICATION IDENTIFIES PATTERNS AND PREDICTORS OF ADHERENCE TO SCREENING RECOMMENDATIONS IN ALBERTA'S TOMORROW PROJECT PARTICIPANTS

Presented by:

- Ala Al Rajabi , Alberta's Tomorrow Project, CancerControl Alberta, Alberta Health Services

D1.4 IMPACT OF THE 2008 ALBERTA TOBACCO REDUCTION ACT ON SECONDHAND SMOKE EXPOSURE: PRELIMINARY FINDINGS FROM A PROSPECTIVE COHORT STUDY

Presented by:

- Alianu Akawung, Biostatistician, Alberta Health Services

D1.5 INTENTIONAL TANNING AMONG CANADIAN ADOLESCENTS: CRAYS 2015

Presented by:

- Victoria Nadalin, Senior Research Associate, Cancer Care Ontario

THURSDAY, JUNE 1, 2017 (CONCURRENT SESSIONS)

10:30AM TO 12:00PM CONCURRENT SESSION D

D2: BEHAVIORAL & SOCIAL EPIDEMIOLOGY - ROOM: KC 301

D2 : ÉPIDÉMIOLOGIE SOCIALE ET COMPORTEMENTALE

- D2.1 SOCIAL SUPPORT AVAILABILITY AND DEPRESSIVE SYMPTOMS AMONG MIDDLE- AND OLDER-AGED ADULTS: A PRELIMINARY ANALYSIS OF BASELINE DATA FROM THE CANADIAN LONGITUDINAL STUDY ON AGING

Presented by:

- Mark Oremus, Associate Professor, University of Waterloo

- D2.2 SOCIAL SUPPORT AVAILABILITY AND COGNITIVE FUNCTION AMONG MIDDLE- AND OLDER-AGED ADULTS: A CROSS-SECTIONAL ANALYSIS OF THE CANADIAN LONGITUDINAL STUDY ON AGING

Presented by:

- Mark Oremus, Associate Professor, University of Waterloo

- D2.3 BI-DIRECTIONAL ASSOCIATION BETWEEN PHYSICAL ACTIVITY AND SEDENTARY BEHAVIOR DURING THE DAY AND NIGHTTIME SLEEP DURATION AMONG 10-13 YEAR OLDS

Presented by:

- Yingyi Lin, Graduate Research Assistant, Queen's University

- D2.4 THE INTERSECTIONAL DISCRIMINATION INDEX: VALIDITY AND RELIABILITY OF A NEW MEASURE FOR POPULATION HEALTH RESEARCH

Presented by:

- Ayden Scheim, PhD candidate, Epidemiology & Biostatistics, Western University

- D2.5 ASSOCIATIONS BETWEEN SELECTED ASPECTS OF HOUSING AND TYPES OF SOCIAL SUPPORT IN PSYCHIATRIC SURVIVORS

Presented by:

- Melody Lam, Student, Western University

THURSDAY, JUNE 1, 2017 (CONCURRENT SESSIONS)

10:30AM TO 12:00PM CONCURRENT SESSION D

D3: CANCER - ROOM: KC 303

- D3.1 POPULATION ATTRIBUTABLE RISK AND IMPACT FRACTIONS FOR LUNG CANCER AND OUTDOOR AIR POLLUTION IN CANADA

Presented by:

- Will D. King, Associate Professor, Queen's University

- D3.2 CANCERS ATTRIBUTABLE TO INFECTIONS IN CANADA

Presented by:

- Karena Volesky, PhD Student, McGill University

- D3.3 LUNG CANCER RISK AT LOW RADON EXPOSURES IN THE CZECH, FRENCH AND CANADIAN URANIUM MINERS (1953–1999)

Presented by:

- Rachel Lane, Radiation and Health Sciences Specialist, Canadian Nuclear Safety Commission

- D3.4 OCCUPATIONAL EXPOSURE TO ASBESTOS AND THE RISK OF KIDNEY CANCER

Presented by:

- Cheryl Peters, Postdoctoral Fellow, Carleton University

D4: NUTRITION, PHYSICAL ACTIVITY & OBESITY - ROOM: KC 305

D4 : NUTRITION, ACTIVITÉ PHYSIQUE ET OBÉSITÉ

- D4.1 EFFECTS OF PRESCRIBED AEROBIC EXERCISE VOLUME ON OBJECTIVELY-ASSESSED PHYSICAL ACTIVITY AND SEDENTARY TIME IN POSTMENOPAUSAL WOMEN: RESULTS FROM THE BREAST CANCER AND EXERCISE TRIAL IN ALBERTA (BETA)

Presented by:

- Jessica McNeil, Postdoctoral Fellow, Alberta Health Services

- D4.2 DIET QUALITY AND MORTALITY RISK IN CANADA: A POPULATION-BASED STUDY USING LINKED SURVEY AND HEALTH ADMINISTRATIVE DATA

Presented by:

- Christopher Tait, PhD Candidate, Dalla Lana School of Public Health, University of Toronto

- D4.3 EFFECTS OF TOTAL AND RECREATIONAL PHYSICAL ACTIVITY ON CANCER INCIDENCE IN THE ALBERTA TOMORROW PROJECT COHORT

Presented by:

- Amanda Barberio, Research Associate Department of Cancer Epidemiology and Prevention Research, Alberta Health Services

- D4.4 THE IMPACT OF MENOPAUSAL STATUS ON ASSOCIATION BETWEEN RECREATIONAL MODERATE-TO-VIGOROUS PHYSICAL ACTIVITY AND OVARIAN CANCER AMONG PARTICIPANTS IN THE PREVENTION OF OVARIAN CANCER IN QUEBEC (PROVAQ) STUDY.

Presented by:

- Anne Grundy, Research Associate, Department of Social and Preventive Medicine, Université de Montréal and Centre de Recherche du CHUM (CRCHUM)

THURSDAY, JUNE 1, 2017 (CONCURRENT SESSIONS)

1:15PM TO 2:45PM CONCURRENT SESSION E

E1: BUILDING CANCER RESEARCH CAPACITY - ROOM: KC 101/103

E1 : RENFORCER LA CAPACITÉ DE RECHERCHE SUR LE CANCER

E1.1 THE CANADIAN PARTNERSHIP FOR TOMORROW PROJECT: A HEALTH RESEARCH RESOURCE

Presented by:

- Paula Robson, Scientific Director, Alberta's Tomorrow Project

E1.2 EXPERIENCES OF CANCER PATIENTS IN TRANSITION STUDY: FROM SURVEY IMPLEMENTATION TO OUTCOME MODELING

Presented by:

- Andrea Coronado, Specialist, Health System Performance, Canadian Partnership Against Cancer

E1.3 BUILDING CANCER ANALYTIC CAPACITY IN CANADA

Presented by:

- Cheryl Louzado, Program Manager, Data Integration, Canadian Partnership Against Cancer

E2: BIostatISTICS - ROOM: KC 301

E2 : BIostatistique

E2.1 USING MACHINE LEARNING METHODS TO CREATE CHRONIC DISEASE CASE DEFINITIONS IN A PRIMARY CARE ELECTRONIC MEDICAL RECORD

Presented by:

- Brendan Lethebe, Student, University of Calgary

E2.2 GENE SET ANALYSIS OF LONGITUDINAL BLOOD PRESSURE

Presented by:

- Elham Khodayari Moez, PhD Student, School of Public Health, University of Alberta

E2.3 LONGITUDINAL TRAJECTORIES OF DISEASE SEVERITY IN CHILDREN WITH EPILEPSY

Presented by:

- Anita Brobbey, PhD Student, University of Calgary

E2.4 TRAJECTORIES OF PARENT-REPORTED HEALTH-RELATED QUALITY OF LIFE IN CHILDREN WITH EPILEPSY

Presented by:

- Tolulope Sajobi, Assistant Professor, University of Calgary

E2.5 MODELING THE RANDOM EFFECTS COVARIANCE MATRIX FOR LONGITUDINAL DATA WITH OVARIATES MEASUREMENT ERROR

Presented by:

- Md Erfanul Hoque, Student, University of Manitoba

THURSDAY, JUNE 1, 2017 (CONCURRENT SESSIONS)

1:15PM TO 2:45PM CONCURRENT SESSION E

E3: CLINICAL- & PHARMACO-EPIDEMIOLOGY - ROOM: KC 303

E3 : ÉPIDÉMIOLOGIE CLINIQUE ET PHARMACO-ÉPIDÉMIOLOGIE

E3.1 PREDICTORS OF FRAGILITY FRACTURE AMONG CHRONIC ORAL GLUCOCORTICOID USERS IN ONTARIO

Presented by:

- Mohamed Amine Amiche, PhD candidate, Leslie Dan Faculty of Pharmacy, University of Toronto

E3.2 COMPARISON OF REGISTERED AND REPORTED OUTCOMES IN RANDOMIZED CLINICAL TRIALS PUBLISHED IN ANESTHESIOLOGY JOURNALS

Presented by:

- Jeffrey Chow, MSc (Epidemiology and Biostatistics) Student, The University of Western Ontario

E3.3 COGNITION AND MOTOR FUNCTION: A NOVEL OUTCOME MEASURE FOR STUDIES OF PRE-DEMENTIA SYNDROMES

Presented by:

- Jacqueline K. Kueper, M.Sc. Candidate, Western University

E3.4 PREVALENCE OF HIGH-RISK NODULES IN SCREENED INDIVIDUALS SELECTED ACCORDING TO STANDARD GUIDELINE CRITERIA VS. A LUNG CANCER RISK PREDICTION CALCULATOR IN THE ALBERTA LUNG CANCER SCREENING PROGRAM

Presented by:

- Niloofar Taghizadeh, Postdoctoral associate, Division of Respiratory Medicine and Charbonneau Cancer Research Institute, University of Calgary, Calgary, AB, Canada

E3.5 ONTARIO PHARMACY SMOKING CESSATION PROGRAM: MORE PHARMACIES NEED TO PARTICIPATE

Presented by:

- Lindsay Wong, MSc student, Leslie Dan Faculty of Pharmacy, University of Toronto

THURSDAY, JUNE 1, 2017 (CONCURRENT SESSIONS)

1:15PM TO 2:45PM CONCURRENT SESSION E

E4: INFECTIOUS DISEASE - ROOM: KC 305

E4 : MALADIES INFECTIEUSES

E4.1 INDIVIDUAL LEVEL MODELLING OF INFECTIOUS DISEASE DATA: EPIILM

Presented by:

- Vineetha Warriyar Kodalore Vijayan, PhD candidate, Postdoctoral Fellow, University of Calgary

E4.2 EPIDEMIOLOGY OF REPORTED CASES OF ENTERIC PATHOGENS IN ALBERTA: 2013-2016

Presented by:

- Kate Snedeker, Surveillance Epidemiologist, Alberta Health Services

E4.3 INCORPORATING CONTACT NETWORK UNCERTAINTY IN INDIVIDUAL LEVEL MODELS OF INFECTIOUS DISEASE USING APPROXIMATE BAYESIAN COMPUTATION

Presented by:

- Waleed Almutiry, PhD candidate at Guelph university and visiting student at Calgary University, University of Guelph

E4.4 SPATIOTEMPORAL PATTERNS OF OCCURRENCE OF SHIGA-TOXIGENIC ESCHERICHIA COLI (STEC) IN SUBMITTED NON-MUNICIPAL DRINKING WATER FROM SOUTHERN ALBERTA

Presented by:

- Colin Reynolds, MSc Student, University of Alberta School of Public Health

E4.5 INVESTIGATING TRENDS IN THE EMERGENCE OF LYME DISEASE IN EASTERN ONTARIO

Presented by:

- Isha Narula, Student Researcher, University of Ottawa

THURSDAY, JUNE 1, 2017 (CONCURRENT SESSIONS)

4:00PM TO 5:30PM CONCURRENT SESSION F

F1: PUBLIC HEALTH/POPULATION HEALTH - ROOM: KC 101/103

F1 : SANTÉ PUBLIQUE ET SANTÉ DE LA POPULATION

- F1.1 ARE INDIGENOUS DETERMINANTS OF HEALTH ASSOCIATED WITH ANXIETY DISORDERS AMONG FIRST NATIONS ADULTS?: FINDINGS FROM THE 2012 ABORIGINAL PEOPLES SURVEY

Presented by:

- Ramanpreet Brar, Master's Student, Western University

- F1.2 ABORIGINAL WOMEN AND THE MINING INDUSTRY

Presented by:

- Raywat Deonandan, Assistant Professor, University of Ottawa

- F1.3 CONSUMER ENGAGEMENT WITH ONLINE CANADIAN MEDIA COVERAGE OF SEASONAL INFLUENZA VACCINATION: AN EXPLORATORY STUDY OF USER GENERATED CONTENT IN WEB 2.0

Presented by:

- Reenika Aggarwal, Researcher, University of Waterloo

- F1.4 CONNECTING PUBLIC HEALTH INTERVENTION DENSITY AND HEPATITIS C INCIDENCE RATES: A PROPOSED ECOLOGIC MULTIGROUP COMPARISON STUDY OF COMMUNITIES IN ONTARIO, 1991-2016

Presented by:

- Charlotte, McEwen, Student, Lakehead University

F2: CANCER - ROOM: KC 301

- F2.1 EXPOSURE TO MEAT-DERIVED CARCINOGENS AND BULKY DNA ADDUCT LEVELS IN NORMAL-APPEARING COLON MUCOSA

Presented by:

- Vikki Ho, Assistant Professor/Research, University of Montreal/University of Montreal Hospital Research Center (CRCHUM)

- F2.2 MAMMOGRAPHIC NON-DENSE AREA AND BREAST CANCER RISK: A CAUSAL INFERENCE APPROACH

Presented by:

- Héctor Velásquez García, Graduate Student, School of Population and Public Health

- F2.3 IMPACT OF RESULTS FROM CANADIAN EPIDEMIOLOGIC STUDIES OF PESTICIDES AND CANCER ON RECENT ASSESSMENTS OF PESTICIDE CARCINOGENICITY BY THE INTERNATIONAL AGENCY FOR RESEARCH ON CANCER (IARC)

Presented by:

- Manisha Pahwa, Research Associate, Cancer Care Ontario

- F2.4 SURVEILLANCE OF PROSTATE CANCER RISK BY OCCUPATION AND INDUSTRY: RESULTS FROM THE CANADIAN CENSUS HEALTH AND ENVIRONMENT COHORT (CanCHEC)

Presented by:

- Jeavana Sritharan, PhD Candidate, Occupational Cancer Research Centre, Cancer Care Ontario; Institute of Medical Science, University of Toronto

- F2.5 HEIGHT DURING CHILDHOOD, ADOLESCENCE AND ADULTHOOD, AND PROSTATE CANCER RISK

Presented by:

- Marie-Elise Parent, Professor, Institut national de la recherche scientifique, University of Quebec

THURSDAY, JUNE 1, 2017 (CONCURRENT SESSIONS)

4:00PM TO 5:30PM CONCURRENT SESSION F

F3: BIOSTATISTICS - ROOM: KC 303

F3 : BIOSTATISTIQUE

F3.1 GEO-DEPENDENT INDIVIDUAL-LEVEL MODELS FOR INFECTIOUS DISEASES TRANSMISSION

Presented by:

- Md Mahsin, Doctoral Student, University of Calgary

F3.2 TRAJECTORIES OF PHYSICAL AND PSYCHOSOCIAL FUNCTIONING IN CHILDREN WITH EPILEPSY: THE MODERATING ROLE OF PARENTAL DEPRESSION

Presented by:

- Anita Brobbey, PhD Student, University of Calgary

F3.3 INFLUENZA VACCINATION FORECAST IN NORTH ZONE, ALBERTA

Presented by:

- Zhengrong Li, Analyst, Alberta Health Services

F3.4 ESTIMATION OF SCREENING SENSITIVITY AND SOJOURN TIME FROM AN ORGANIZED SCREENING PROGRAM

Presented by:

- Huan Jiang, Biostatistician, Assistant Professor, Cancer Care Ontario

F3.5 EXPLORATION OF DIFFERENT ADAPTATION OF GENERALIZED ESTIMATING FOR THE ANALYSIS OF CLUSTERED LONGITUDINAL DATA

Presented by:

- Elmagbrok Masaoud, Senior Statistician/ Adjunct Professor, Canadian Food Inspection Agency / University of Ottawa

F4: ENVIRONMENTAL & OCCUPATIONAL/SURVEILLANCE & SPATIAL EPIDEMIOLOGY - ROOM: KC 305

F4 : ÉPIDÉMIOLOGIE ENVIRONNEMENTALE ET PROFESSIONNELLE / ÉPIDÉMIOLOGIE SPATIALE ET DE LA SURVEILLANCE

F4.1 SMOKING CESSATION IN REGIONAL CANCER CENTRES: COLLECTION AND REPORTING OF DATA ON TOBACCO USE AND SMOKING CESSATION ACTIVITIES

Presented by:

- Mohammad Haque, Research Associate, Cancer Care Ontario

F4.2 AUTOMATION OF SYNDROMIC SURVEILLANCE: EARLY ABERRATION DETECTION SYSTEM (EADS) WITH ALBERTA REAL-TIME SYNDROMIC SURVEILLANCE NET (ARTSSN) - INFLUENZA-LIKE ILLNESS CASE

Presented by:

- Sarah Edwards, Director, Surveillance & Reporting, Alberta Health Services

F4.3 SPATIAL AND TEMPORAL ANALYSIS OF CHLAMYDIA TRACHOMATIS IN NEWFOUNDLAND AND LABRADOR (NL) AND ITS POTENTIAL LINKAGE TO MIGRATORY EMPLOYMENT.

Presented by:

- James Valcour, Associate Professor of Epidemiology, Memorial University of Newfoundland

F4.4 IMPACTS OF OTTAWA'S CENTRAL EXPERIMENTAL FARM ON AMBIENT AIR POLLUTION, AND TEMPERATURE: FINDINGS FROM A MOBILE MONITORING CAMPAIGN

Presented by:

- Keith Van Ryswyk, MSc candidate, Carleton University

POSTER PRESENTATIONS AT-A-GLANCE

3:15PM TO 4:30PM POSTER PRESENTERS - KC GALLERIA 200

- 1 IMPACT OF VITAMIN D INTAKE ON SERUM VITAMIN D STATUS IN CANADIAN BREAST CANCER PATIENTS

Presented by:

 - Amit Manocha, PhD Candidate, Student Researcher, University of Calgary
- 2 METHODS FILTERS AND 'AND NOT' LIMITS FILTERS FOR SYSTEMATIC REVIEWS HAVE HIGH SENSITIVITY AND MARKEDLY REDUCE THE NUMBER OF ARTICLES NEED TO READ: AN ANALYTIC SURVEY

Presented by:

 - Dalton Budhram, Undergraduate Student, McMaster University
- 3 ASSOCIATIONS BETWEEN SPOUSES' HEALTH BEHAVIOURS BEFORE AND AFTER ONE PARTNER IS DIAGNOSED WITH DIABETES: RESULTS FROM THE LIFELINES COHORT STUDY

Presented by:

 - Rachel Burns, Postdoctoral Fellow, McGill University
- 4 TRANSDERMAL NITROGLYCERIN THERAPY IN LOWER LIMB PERIPHERAL ARTERIAL DISEASE: A SYSTEMATIC REVIEW

Presented by:

 - Michael Caputo, Medical Student, Northern Ontario School of Medicine
- 5 SUPERVISOR AND ORGANIZATIONAL FACTORS ASSOCIATED WITH JOB MODIFICATIONS

Presented by:

 - Catherine Chambers-Bedard, MPH Candidate, Lakehead University
- 6 THE COMBINED EFFECT OF SOCIOECONOMIC STATUS AND COMPENSATION POLICY ON RETURN TO WORK.

Presented by:

 - Catherine Chambers-Bedard, MPH Candidate, Lakehead University
- 7 FALLS AND FEAR OF FALLING IN OLDER ADULTS AFTER TOTAL JOINT ARTHROPLASTY

Presented by:

 - Serena Chen, Graduate Student, University of Alberta School of Public Health
- 8 DIABETES SIGNIFICANTLY INCREASES THE RISK OF DEPRESSION IN LONGITUDINAL STUDIES: SYSTEMATIC REVIEW, META-ANALYSIS AND POPULATION ATTRIBUTABLE FRACTIONS.

Presented by:

 - Batholomew Chireh, Student, University of Saskatchewan
- 9 EVALUATING TNM STAGE PROGNOSTIC ABILITY IN A POPULATION-BASED COHORT OF GASTRIC CANCER PATIENTS IN A LOW INCIDENCE COUNTRY

Presented by:

 - Alyson Mahar, Postdoctoral Research Associate, Sunnybrook Health Sciences Centre
- 10 MENTAL HEALTH STATUS AND SERVICE UTILIZATION AMONG ETHNIC GROUPS IN ONTARIO, CANADA

Presented by:

 - Jenny Gatov, Epidemiologist, Institute for Clinical Evaluative Sciences
- 11 FACTORS ASSOCIATED WITH SHORTER NIGHT-TIME SLEEP IN TODDLERS: THE SURVEY OF YOUNG CANADIANS (SYC)

Presented by:

 - Christy Costanian, PhD Student, York University

3:15PM TO 4:30PM POSTER PRESENTERS - KC GALLERIA 200

- | | |
|----|--|
| 12 | <p>WRITING SKILLS ENHANCEMENT FOR PUBLIC HEALTH PROFESSIONALS IN RWANDA</p> <p>Presented by:</p> <ul style="list-style-type: none"> - Raywat Deonandan, Assistant Professor, University of Ottawa |
| 13 | <p>ADVANCED MATERNAL AGE: ETHICAL AND MEDICAL CONSIDERATIONS FOR ASSISTED REPRODUCTIVE TECHNOLOGY</p> <p>Presented by:</p> <ul style="list-style-type: none"> - Raywat Deonandan, Assistant Professor, University of Ottawa |
| 14 | <p>POST-COLONOSCOPY COLORECTAL CANCERS. A STEP TOWARDS IDENTIFICATION OF ROOT CAUSES AND POTENTIAL POINTS OF INTERVENTIONS</p> <p>Presented by:</p> <ul style="list-style-type: none"> - Saiganesh Dhannewar, Research Assistant, University of Alberta |
| 15 | <p>HANDLING UNCERTAINTY IN TRIAL-BASED ECONOMIC EVALUATIONS: A REVIEW OF THE USE OF STATISTICAL METHODS</p> <p>Presented by:</p> <ul style="list-style-type: none"> - Juan Pablo Diaz-Martinez, Student, McMaster University |
| 16 | <p>REACH AND PATTERN OF USE OF ASSISTED METHODS OF SMOKERS QUITTING IN ONTARIO</p> <p>Presented by:</p> <ul style="list-style-type: none"> - Sarah Edwards, Director, Surveillance and Reporting, Alberta Health Services |
| 17 | <p>BREAST CANCER SURVIVAL BY MOLECULAR SUBTYPE IN ONTARIO, CANADA: A POPULATION-BASED ANALYSIS OF CANCER REGISTRY DATA</p> <p>Presented by:</p> <ul style="list-style-type: none"> - Saber Fallahpour, Senior Research Associate, Cancer Care Ontario |
| 18 | <p>THE ASSOCIATION BETWEEN SOCIAL PARTICIPATION AND DEPRESSION SYMPTOMS AMONG MIDDLE-AGED AND ELDERLY CHINESE ADULTS</p> <p>Presented by:</p> <ul style="list-style-type: none"> - Mingying Fangr, Ph.D candidate, University of Waterloo |
| 19 | <p>HIV AND SYPHILIS PREVALENCE AND RISK FACTORS AMONG DRUG USERS: RESULTS OF RESPONDENT-DRIVEN SAMPLING IN GUANGZHOU</p> <p>Presented by:</p> <ul style="list-style-type: none"> - Mingying Fangr, Ph.D candidate, University of Waterloo |
| 20 | <p>AN ASSESSMENT OF THE EFFECTIENESS OF EPIDEMIOLOGY ONLINE DISTANCE LEARNING</p> <p>Presented by:</p> <ul style="list-style-type: none"> - Mateo Farfan, Student, University of Ottawa |
| 21 | <p>PSYCHOSOCIAL OUTCOMES TWELVE MONTHS FOLLOWING A DOSE-RESPONSE AEROBIC EXERCISE INTERVENTION IN POSTMENOPAUSAL WOMEN</p> <p>Presented by:</p> <ul style="list-style-type: none"> - Megan Farris, Epidemiology Research Associate/ Project Coordinator, Alberta Health Services |
| 22 | <p>THE ALBERTA MOVING BEYOND BREAST CANCER (AMBER) COHORT STUDY: RECRUITMENT, ASSESSMENT, AND DESCRIPTION OF THE FIRST 1023 PARTICIPANTS</p> <p>Presented by:</p> <ul style="list-style-type: none"> - Megan Farris, Epidemiology Research Associate/ Project Coordinator, Alberta Health Services |

3:15PM TO 4:30PM POSTER PRESENTERS - KC GALLERIA 200

- | | |
|----|--|
| 23 | INTERVENTIONS FOR REDUCING THE DURATION OF THE ACUTE DIARRHEA AND GASTROENTERITIS IN CHILDREN: A NETWORK META-ANALYSIS Presented by: - Ivan D. Florez, PhD Student, McMaster University |
| 24 | WEIGHT TRAJECTORIES, ADIPOSITY MEASUREMENTS OF OBESITY AND SURVIVAL AFTER PROSTATE CANCER DIAGNOSIS Presented by: - Christine Friedenreich, Scientific Leader, Alberta Health Services |
| 25 | IMPROVING LEGIONELLOSIS SPATIAL CLUSTER DETECTION USING MULTIPLE EXPOSURE ADDRESSES PER CASE Presented by: - Lennon Li, Biostatistical Specialist, Public Health Ontario |
| 26 | CANCER SCREENING AND PERCEIVED SUSCEPTIBILITY OF DEVELOPING CANCER: A CROSS-SECTIONAL ANALYSIS OF THE ALBERTA TOMORROW PROJECT Presented by: - Meghan Gilfoyle, Student, University of Waterloo |
| 27 | QUALITY OF WEB-BASED INFORMATION FOR THE 10 MOST COMMON FRACTURES Presented by: - Lydia Ginsberg, Research Assistant/Student, McMaster University |
| 28 | IS QUALITY OF DIABETES CARE ASSOCIATED WITH DEPRESSIVE SYMPTOMS IN ADULTS WITH DIABETES? A STUDY OF 19 EUROPEAN COUNTRIES Presented by: - Eva Graham, PhD Candidate, Epidemiology, McGill University |
| 29 | IDENTIFYING RELEVANT POPULATION-BASED INTERVENTION PROGRAMS TO IMPACT THE PREVALENCE OF CANCER-RELATED LIFESTYLE RISK FACTORS IN CANADA Presented by: - Xin Grevers, Research study coordinator, Alberta Health Services |
| 30 | A MULTI-CENTRE RETROSPECTIVE STUDY OF EVALUATION TIMES IN PRIOR LIVING KIDNEY DONORS Presented by: - Steven Habbous, PhD student, Western University |
| 31 | MEAT-DERIVED CARCINOGENS AND THE RISK OF COLORECTAL CANCER; A META-ANALYSIS. Presented by: - Vikki Ho, Assistant Professor/Research, University of Montreal/University of Montreal Hospital Research Center (CRCHUM) |
| 32 | THE ASSOCIATION BETWEEN FREQUENCY OF RELIGIOUS PARTICIPATION AND COGNITIVE FUNCTION: PRELIMINARY ANALYSIS OF THE CANADIAN LONGITUDINAL STUDY ON AGING Presented by: - Shera Hosseini, Graduate Student, University of Waterloo |
| 33 | STUDYING CYCLE TRACKS AND CYCLIST SAFETY IN TORONTO THROUGH ONLINE DATA MINING Presented by: - Martha Hunter, Master's Student, Lakehead University |

3:15PM TO 4:30PM POSTER PRESENTERS - KC GALLERIA 200

- 34 LONG-TERM RISK OF RECURRENCE AFTER DISCONTINUING ANTICOAGULANTS FOR A FIRST UNPROVOKED VENOUS THROMBOEMBOLISM: A SYSTEMATIC REVIEW AND META-ANALYSIS

Presented by:

- Faizan Khan, Master of Science Student, University of Ottawa

- 35 STATISTICAL METHODS FOR PROJECTING LIFESTYLE EXPOSURE PREVALENCE TRENDS IN CANADA

Presented by:

- Farah Khandwala, Statistical Associate, Alberta Health Services

- 36 FACTORS INFLUENCING EMPLOYER PARTICIPATION IN RESEARCH

Presented by:

- Vicki Kristman, Associate Professor, Lakehead University

- 37 SUSCEPTIBILITY OF DEPRESSION AMONG CANADIAN UNIVERSITY STUDENTS

Presented by:

- Philip Lam, Health Science Student, University of Ottawa

- 38 HEALTH IN THE RURAL TOWNS OF LIMA, PERU

Presented by:

- Philip Lam, Health Science Student, University of Ottawa

- 39 BEALL'S LIST: A VIABLE TOOL FOR IDENTIFYING PREDATORY SCIENCE JOURNALS?

Presented by:

- Meghan Lavery, Student, University of Ottawa

- 40 THE RELATIONSHIP BETWEEN AGE AND SERUM VITAMIN D STATUS IN A POPULATION-BASED COHORT OF CANADIAN BREAST CANCER PATIENTS

Presented by:

- Nicholas Massaro, Student, University of Calgary

- 41 TRENDS IN SERUM VITAMIN D IN A POPULATION-BASED COHORT OF ALBERTAN BREAST CANCER PATIENTS

Presented by:

- Heather Merry, Statistical Research Associate, Alberta Health Services

- 42 SELECTIVE OUTCOME REPORTING IN RANDOMIZED CONTROLLED TRIALS OF LUNG CANCER IMMUNOTHERAPY

Presented by:

- Reenika Aggarwal, Researcher, University of Waterloo

- 43 CLINICAL UTILITY OF SERUM 25-HYDROXYVITAMIN D IN THE DIAGNOSIS OF INSULIN RESISTANCE: A CROSS-SECTIONAL ANALYSIS OF NHANES, 2001-2010

Presented by:

- Banaz Al-khalidi, PhD Candidate, York University

- 44 PRECISION REMODELLING AND DETERMINING CUT-OFF SCORES OF THE IOWA INFANT FEEDING ATTITUDE SCALE TO IMPROVE CLINICAL USE AND EFFICACY AMONG PRENATAL WOMEN IN CANADA

Presented by:

- Nouf AlKusayer, Graduate student, Memorial University of Newfoundland and Labrador

3:15PM TO 4:30PM POSTER PRESENTERS - KC GALLERIA 200

- | | |
|----|--|
| 45 | EFFECTIVENESS OF ORAL BISPHOSPHONATES IN REDUCING FRACTURE RISK AMONG CHRONIC ORAL GLUCOCORTICOID USERS: A POPULATION-BASED STUDY Presented by: - Mohamed Amine Amiche, PhD candidate, Leslie Dan Faculty of Pharmacy, University of Toronto |
| 46 | THE EFFECTS OF PHACOEMULSIFICATION ON INTRA-OCULAR PRESSURE AND TOPICAL MEDICATION USE IN PATIENTS WITH GLAUCOMA: A SYSTEMATIC REVIEW AND META-ANALYSIS THREE-YEAR DATA Presented by: - James Armstrong, MD/PhD Candidate, Schulich School of Medicine |
| 47 | DEPRESSIVE SYMPTOMATOLOGY AND LIFELONG MUSIC EXPERIENCE: A CROSS-SECTIONAL STUDY Presented by: - Jennifer Asselstine, M.HSc. Candidate/Graduate Assistant, Lakehead University |
| 48 | THE RIVERMEAD POST-CONCUSSION QUESTIONNAIRE PREDICTS SOCIAL, MENTAL, AND OVERALL SELF-REPORTED RECOVERY SIX MONTHS AFTER MILD TRAUMATIC BRAIN INJURY IN OLDER ADULTS Presented by: - Jennifer Asselstine, M.HSc. Candidate/Graduate Assistant, Lakehead University |
| 49 | TRANSGENDER-INCLUSIVE MEASURES OF SEX/GENDER FOR POPULATION HEALTH SURVEYS: EVALUATION AND RECOMMENDATIONS Presented by: - Greta Bauer, Associate Professor and Graduate Chair, Epidemiology and Biostatistics, Western University |
| 50 | DATA PRIVACY AND RESEARCH: NEW CHALLENGES FROM THE COURTS Presented by: - Greta Bauer, Associate Professor and Graduate Chair, Epidemiology and Biostatistics, Western University |
| 51 | ANNUAL VERSUS BIENNIAL SCREENING: PERFORMANCE MEASURES IN CONCURRENT COHORTS WITHIN THE ONTARIO BREAST SCREENING PROGRAM Presented by: - Kristina Blackmore, Research Associate, Cancer Care Ontario |
| 52 | PREDICTORS OF ADHERENCE TO POSITIVE AIRWAY PRESSURE THERAPY IN CHILDREN: A SYSTEMATIC REVIEW Presented by: - Henrietta Blinder, Epidemiology Graduate Student, University of Ottawa |
| 53 | OCCUPATIONAL EXPOSURE TO SILICA AND THE RISK OF KIDNEY CANCER Presented by: - Laura Bogaert, Student, University of Toronto |
| 54 | ARE PHYSICAL ACTIVITY AND CONSUMPTION OF FRUITS AND VEGETABLES ASSOCIATED WITH GLAUCOMA? Presented by: - Ramanpreet Brar, Master's Student, Western University |
| 55 | PROJECTING CANCER INCIDENCE IN CANADA: LOOKING BACK TO THE FUTURE Presented by: - Abbey Poirier, Epidemiology Research Associate, Alberta Health Services |

WEDNESDAY, MAY 31, 2017

3:15PM TO 4:30PM POSTER PRESENTERS - KC GALLERIA 200

- 56 TAILORING THE WORLD HEALTH ORGANIZATION SURGICAL SAFETY CHECKLIST TO PEDIATRICS: AN IMPLEMENTATION AND EVALUATION STUDY PROPOSAL

Presented by:

- Laura Rivera, Research Associate, O'Brien Institute for Public Health, University of Calgary

- 57 AN AUDIT OF IMPLANTED DEVICE-ASSOCIATED INFECTIONS AT THE ALBERTA CHILDREN'S HOSPITAL: A MIXED CHART REVIEW/ELECTRONIC ADMINISTRATIVE DATA STUDY

Presented by:

- Hasan Abdullah, Research Assistant, University of Calgary

- Ashleigh Gibb, Research Assistant, University of Calgary

- 58 AREA-LEVEL DEPRIVATION AND DENTAL HEALTH RELATED EMERGENCY DEPARTMENT VISITS IN ALBERTA, 2011 TO 2015

Presented by:

- Mei Zhang, Senior Analyst, Alberta Health Services

- 59 SUICIDE AND SUICIDE-RELATED HEALTH CARE UTILIZATION IN ALBERTA: AN ANALYSIS OF RATES AND TRENDS FROM 2011 TO 2015

Presented by:

- Julie Zhang, Alberta Health Services

CUMMING SCHOOL OF MEDICINE | Celebrating 50 years of changing lives

TOGETHER WE'RE
CREATING THE
FUTURE OF HEALTH

For more information visit cumming.ucalgary.ca/50years



**UNIVERSITY OF
CALGARY**

2:45PM TO 4:00PM POSTER PRESENTERS - KC GALLERIA 200

- 1 DEVELOPING INTEGRATED SPATIOTEMPORAL SURVEILLANCE SYSTEMS: A PROTOTYPE USING INFLUENZA DATA

Presented by:

 - Lennon Li, Biostatistical Specialist, Public Health Ontario
- 2 MEASUREMENT INVARIANCE OF THE MEDICAL OUTCOMES STUDY SOCIAL SUPPORT SURVEY IN CORONARY ARTERY DISEASE

Presented by:

 - Zhiying Liang, Department of Community Health Institute for Public Health, University of Calgary
- 3 ADULT PRIMARY CARE USERS WITH AND WITHOUT BODY MASS INDEX IN ELECTRONIC MEDICAL RECORDS FROM THE MANITOBA PRIMARY CARE RESEARCH NETWORK

Presented by:

 - Lisa Lix, Surgeon, Professor, University of Manitoba
- 4 AGE AND SEX INFLUENCES ON HEALTH CARE UTILIZATION THROUGH THE ONTARIO TELEMEDICINE NETWORK

Presented by:

 - Jessica Lowey, Student, Lakehead University
- 5 DO HEALTH LINK CALLS PREDICT EMERGENCY DEPARTMENT VISITS FOR INFLUENZA-LIKE ILLNESS

Presented by:

 - Andrew Macmillan, Surveillance Analyst, Alberta Health Services
- 6 IMPROVING ACCESS FOR URGENT SURGICAL CASES AT THE ALBERTA CHILDREN'S HOSPITAL: A REALIST REVIEW

Presented by:

 - Ali MacRobie, Research Assistant, University of Calgary
- 7 THE ASSOCIATION BETWEEN BEHAVIOURS IN ALZHEIMER'S DISEASE AND CAREGIVER HEALTH-RELATED QUALITY-OF-LIFE: A CROSS-SECTIONAL STUDY

Presented by:

 - Melissa Majoni, Student, University of Waterloo
- 8 QUANTITATIVE RISK-BASED SAMPLING APPROACH FOR LISTERIA MONOCYTOGENES IN READY-TO-EAT MEAT AND POULTRY PRODUCTS

Presented by:

 - Elmabrok Masaoud, Surgeon, Senior Statistician/ Adjunct Professor, Canadian Food Inspection Agency / University of Ottawa
- 9 WHO CARES: THE IMPACT OF SUSPECTED MINING-RELATED LUNG CANCER ON CAREGIVERS?

Presented by:

 - Nancy Lightfoot, Associate Professor, Laurentian University

2:45PM TO 4:00PM POSTER PRESENTERS - KC GALLERIA 200

-
- 10 SYSTEMATIC REVIEW OF DEPRESSION AS AN OUTCOME OF MILD TRAUMATIC BRAIN INJURY (MTBI): AN EXTENSION OF THE RESULTS OF THE INTERNATIONAL COLLABORATION ON MILD TRAUMATIC BRAIN INJURY PROGNOSIS (ICOMP)
- Presented by:
- Charlotte McEwen, Student, Lakehead University
-
- 11 GESTATIONAL DIABETES AND RISK OF CARDIOVASCULAR DISEASE LATER IN LIFE: A RETROSPECTIVE COHORT STUDY
- Presented by:
- Safyer McKenzie-Sampson, Master's student, McGill University
-
- 12 DETERMINANTS OF MATERNAL MORTALITY: A COMPARISON OF GEOGRAPHIC DIFFERENCES IN NORTHERN AND SOUTHERN REGIONS OF CAMEROON
- Presented by:
- Catherine Meh, Student, Western University
-
- 13 EXAMINING THE CONCURRENT IMPACT OF MULTIPLE HEALTHY WEIGHT BEHAVIOURS ON OVERWEIGHT AND OBESITY AMONG ONTARIO'S ADOLESCENTS
- Presented by:
- Sandya Menon, Research Assistant, Public Health Ontario
-
- 14 EVOLUTION, FROM CHILDHOOD TO YOUNG ADULTHOOD, OF ASTHMA PHENOTYPES DEFINED BY UTILIZATION OF HEALTH SERVICES IN A PROVINCE-WIDE BIRTH COHORT IN QUEBEC
- Presented by:
- Miceline Mesidor, Student, Montreal University
-
- 15 INFLUENCE OF DIETARY ANTIOXIDANT AND OXIDANT INTAKE ON LEUKOCYTE TELOMERE LENGTH
- Presented by:
- Alexis Mickle, Graduate Student, Alberta Health Services
-
- 16 RELIGION/SPIRITUALITY AND CANCER SCREENING IN THE ALBERTA TOMORROW PROJECT: AN EXPLORATORY ANALYSIS OF BASELINE DATA
- Presented by:
- Susan Mirabi, Student, University of Waterloo
-
- 17 LINKING GENOME WIDE ASSOCIATION STUDIES AND RNA VIA EXPRESSION QUANTITATIVE TRAIT LOCI, WITH AN APPLICATION TO A STUDY OF INFLAMMATORY BOWEL DISEASE
- Presented by:
- Fahimeh Moradi, Msc Student, University of Alberta
-
- 18 PREVENTING RESIDUAL CONFOUNDING IN STUDIES OF COMPOSITE EXPOSURES: AN EXAMPLE FROM QUEBEC'S CHILDCARE PROGRAM
- Presented by:
- Tanya Murphy, PhD student, McGill University
-
- 19 ASSESSING A BAN ON THE USE OF UV TANNING EQUIPMENT AMONG ADOLESCENTS IN ONTARIO, CANADA: FIRST YEAR RESULTS
- Presented by:
- Victoria Nadalin, Senior Research Associate, Cancer Care Ontario
-

2:45PM TO 4:00PM POSTER PRESENTERS - KC GALLERIA 200

- 20 EXERCISE DOSE EFFECTS ON ADIPOSITY PERSIST 12 MONTHS AFTER AN EXERCISE INTERVENTION IN POSTMENOPAUSAL WOMEN
Presented by:
- Heather Neilson, Research Associate, Alberta Health Services
-
- 21 COMORBID SUBSTANCE USE DISORDERS, MAJOR DEPRESSION AND GENERALIZED ANXIETY DISORDERS IN NATIONALLY REPRESENTATIVE SAMPLES: A SYSTEMATIC REVIEW AND META-ANALYSIS
Presented by:
- VIVIAN ONAEMO, Student, University of Saskatchewan
-
- 22 ALCOHOL DEPENDENCE AND THE PERSISTENCE OF MAJOR DEPRESSION
Presented by:
- VIVIAN ONAEMO, Student, University of Saskatchewan
-
- 23 SOURCE ATTRIBUTION OF FOODBORNE SHIGA TOXIN-PRODUCING ESCHERICHIA COLI INFECTION USING A META-ANALYSIS OF CASE-CONTROL STUDIES OF SPORADIC INFECTIONS: A PROTOCOL
Presented by:
- Carolina Oremus, Postdoctoral Fellow, University of Waterloo
-
- 24 SKIN CANCER IN CANADA ATTRIBUTABLE TO ULTRAVIOLET RADIATION, INDOOR TANNING, AND SUN BEHAVIOUR HABITS
Presented by:
- Dylan O'Sullivan, PhD Candidate, Queen's University
-
- 25 A QUALITY ASSESSMENT OF HEALTH MANAGEMENT INFORMATION SYSTEM (HMIS) DATA FOR MATERNAL AND CHILD HEALTH IN JIMMA ZONE, ETHIOPIA
Presented by:
- Mariame Ouedraogo, MSc Student in Epidemiology, University of Ottawa, School of Epidemiology, Public Health and Preventive Medicine
-
- 26 INCREASING AND BALANCING THE POWER OF MULTIPLE TESTS IN OPTIMAL TREATMENT DURATION CLINICAL TRIALS -- A NEW ANALYSIS PLAN WHEN THESE DURATIONS HAVE OVERLAPS
Presented by:
- Yongdong Ouyang, Student, University of British Columbia
-
- 27 SEDENTARY WORK AND THE RISKS OF COLON AND RECTAL CANCER BY ANATOMICAL SUB-SITE IN THE CANADIAN CENSUS HEALTH AND ENVIRONMENT COHORT (CANCHEC)
Presented by:
- Manisha Pahwa, Research Associate, Cancer Care Ontario
-
- 28 RISK FACTORS FOR HEALTHCARE-ASSOCIATED CLOSTRIDIUM DIFFICILE INFECTION (HA-CDI), 2013-2015, SCARBOROUGH AND ROUGE HOSPITAL (SRH)
Presented by:
- Senthuri Paramalingam, Clinical Epidemiologist, The Scarborough and Rouge Hospital

2:45PM TO 4:00PM POSTER PRESENTERS - KC GALLERIA 200

- | | |
|----|--|
| 29 | IMPROVING THE CANADIAN INSTITUTE FOR HEALTH RESEARCH'S (CIHR) GRANT APPLICATIONS: A SWOT ANALYSIS OF THE POLICIES GOVERNING THE FUNDING PROCESS Presented by: - Raywat Deonandan, Assistant Professor, University of Ottawa |
| 30 | HOW WE MEASURE CANCER IN FIRST NATIONS, INUIT AND MÉTIS COMMUNITIES: A KNOWLEDGE EXCHANGE PROJECT Presented by: - Maegan Prummel, Senior Research Associate, Cancer Care Ontario |
| 31 | SUBSTANCE USE DISORDER AMONG EMERGING AND YOUNG ADULTS: AN EPIDEMIOLOGICAL STUDY Presented by: - Rana Qadeer, Student, McMaster University |
| 32 | EVIDENCE REVERSAL AND RANDOMIZED CONTROLLED TRIALS WITHIN THE NEW ENGLAND JOURNAL OF MEDICINE: AN ANALYSIS OF TRIAL CHARACTERISTICS FROM 2000 TO 2016 Presented by: - Riaz Qureshi, Student, University of Western Ontario |
| 33 | A SIMULATION STUDY TO ASSESS THE IMPACT ON SCREENING RESULTS OF INTRODUCING NEXT-GENERATION SEQUENCING TECHNOLOGY INTO NEWBORN SCREENING Presented by: - Alvi Rahman, MSc. Student, University of Ottawa |
| 34 | LEVERAGING CLINICAL INFORMATION SYSTEMS TO FACILITATE KNOWLEDGE TRANSLATION IN EMERGENCY MEDICINE Presented by: - Laura Rivera, Research Associate, University of Calgary |
| 35 | A COMPARISON OF CENTRAL AND DISSEMINATED SCHOOL ABSENTEEISM SYNDROMIC SURVEILLANCE PUBLIC HEALTH PRACTICE IN TWO CANADIAN PROVINCES Presented by: - Laura Rivera, Research Associate, University of Calgary |
| 36 | ESTIMATING COMBINED POPULATION ATTRIBUTABLE RISKS FOR MULTIPLE LIFESTYLE RISK FACTORS: EXAMINING RISK OF COLORECTAL CANCER IN ALBERTA Presented by: - Yibing Ruan, Statistical Associate, Alberta Health Services |
| 37 | OCCUPATIONAL CANCER IN ONTARIO: RISK FACTORS AND PREVENTION Presented by: - Elizabeth Rydz, Research Associate, Cancer Care Ontario |
| 38 | RISKS AND BENEFITS OF MOOD-STABILIZER TREATMENT IN PREGNANT WOMEN WITH BIPOLAR DISORDER: A POPULATION-BASED COHORT STUDY Presented by: - Misbah Salim, Masters Student Western University |

2:45PM TO 4:00PM POSTER PRESENTERS - KC GALLERIA 200

- | | |
|----|--|
| 39 | LIFETIME CAFFEINE INTAKE AND THE RISK OF EPITHELIAL OVARIAN CANCER Presented by: - Simran Sandhu, MSc. Epidemiology Candidate, Queen's University |
| 40 | ALZHEIMER'S DISEASE AND RELATED DEMENTIA IN INDIGENOUS POPULATIONS: A SYSTEMATIC REVIEW OF RISK FACTORS Presented by: - Grace Scott, Student, Laurentian University |
| 41 | INTAKE OF DIETARY FIBRE AND LIFETIME NONSTEROIDAL ANTI-INFLAMMATORY DRUG (NSAID) USE AND THE INCIDENCE OF COLORECTAL POLYPS IN A POPULATION SCREENED FOR COLORECTAL CANCER Presented by: - Eileen Shaw, Research Associate, Alberta Health Services |
| 42 | THE EFFECT OF PERCEIVED STRESS ON CANCER INCIDENCE USING DATA FROM ALBERTA'S TOMORROW PROJECT Presented by: - Eileen Shaw, Research Associate, Alberta Health Services |
| 43 | THE CROSSOVER DESIGN FOR STUDIES OF INFERTILITY: A METHODOLOGICAL APPRAISAL Presented by: - Daniel Shi, Undergraduate Student, McMaster University |
| 44 | EFFECTS OF AMBIENT AIR POLLUTION ON INCIDENT PARKINSON'S DISEASE IN ONTARIO, 2001 TO 2013: A POPULATION-BASED COHORT STUDY Presented by: - Sae Ha Shin, Student, Public Health Ontario |
| 45 | THE IMPACT OF ORGANIZED BREAST ASSESSMENT ON OVERALL SURVIVAL BY STAGE FOR SCREENED WOMEN DIAGNOSED WITH INVASIVE BREAST CANCER Presented by: - Courtney R. Smith, Research Associate, Cancer Care Ontario |
| 46 | USING TABLEAU DASHBOARDS TO COMMUNICATE ENTERIC PATHOGEN SURVEILLANCE INFORMATION Presented by: - Kate Snedeker, Surveillance Epidemiologist, Alberta Health Services |
| 47 | ASSESSMENT OF AN ALGORITHM FOR DETECTING HIGHER THAN EXPECTED COUNTS OF ENTERIC PATHOGENS IN ALBERTA Presented by: - Kate Snedeker, Surveillance Epidemiologist, Alberta Health Services |
| 48 | MATERNAL HEALTH CARE ACCESS IN RURAL COMMUNITIES IN SOUTHWESTERN UGANDA: ANTENATAL CARE (ANC) ATTENDANCE AND DELIVERY EXPERIENCES AMONG INDIGENOUS BATWA AND NON-INDIGENOUS BAKIGA WOMEN Presented by: - Vivienne Steele, Student (Masters), University of Guelph |

2:45PM TO 4:00PM POSTER PRESENTERS - KC GALLERIA 200

- 49 DETERMINANTS OF PHYSICAL ACTIVITY IN A COHORT OF PROSTATE CANCER SURVIVORS
Presented by:
- Chelsea Stone, Masters Student, Alberta Health Services
-
- 50 THE EFFECT OF SYNTHETIC OXYTOCIN USED FOR INDUCTION OR AUGMENTATION OF LABOR ON EARLY BREASTFEEDING INITIATION AND CONTINUATION: A SYSTEMATIC REVIEW AND META-ANALYSIS
Presented by:
- Anusree Subramonian, Msc. Clinical epidemiology student, Memorial University of Newfoundland
-
- 51 SOCIOECONOMIC STATUS AND RISK PERCEPTIONS OF SMOKING: A SYSTEMATIC REVIEW
Presented by:
- Imran Syed, Student, Centre for Addiction Mental Health; University of Western Ontario Department of Epidemiology and Biostatistics
-
- 52 INVESTIGATING THE VALUE OF A TAILORED KNOWLEDGE SYNTHESIS APPROACH FOR RARE DISEASES: FOCUS GROUPS WITH VARIOUS STAKEHOLDERS
Presented by:
- Kylie Tingley, PhD candidate, University of Ottawa
-
- 53 MATHEMATICAL MODELLING OF THE WEST AFRICAN EBOLA VIRUS EPIDEMIC
Presented by:
- John Marcello Colabella, Student, Mount Royal University
-
- 54 PREDICTION OF NEONATAL SEPSIS USING NEWBORN SCREENING ANALYTE DATA
Presented by:
- Lindsay Wilson, Research Assistant, Ottawa Hospital Research Institute
-
- 55 EXPLORING THE RELATIONSHIP BETWEEN NEWBORN SCREENING ANALYTES AND CHILDHOOD OUTCOMES RELATED TO AUTISM SPECTRUM DISORDERS
Presented by:
- Lindsay Wilson, Research Assistant, Ottawa Hospital Research Institute
-
- 56 SUBTLE DEGREES OF FRAILTY RESULT IN ADVERSE CARDIAC SURGERY OUTCOMES
Presented by:
- Emma Wilson-Pease, Research Assistant, Nova Scotia Health Authority
-
- 57 BREAST CANCER RISK AND STAGE AT DIAGNOSIS AMONG IMMIGRANT AND NON-IMMIGRANT WOMEN IN BRITISH COLUMBIA
Presented by:
- Ryan Woods, PHD Student, University of British Columbia/BC Cancer Agency
-
- 58 FALL RISK CLASSIFICATION IN COMMUNITY-DWELLING OLDER ADULTS USING A SMART WEARABLE AND THE RESIDENT ASSESSMENT INSTRUMENT (RAI) SYSTEM
Presented by:
- Rena Yang, Graduate Student, University of Waterloo
-
- 59 SPATIAL ASSOCIATIONS BETWEEN METRICS OF NOISE, AND TRAFFIC-RELATED AIR POLLUTION: A PASSIVE MONITORING CAMPAIGN IN OTTAWA, CANADA
Presented by:
- Natasha Prince, M.Sc. candidate, Carleton University